

Dresden Dreams

Block of the Month
Bev Remillard



Dresden Dreams

Block of the Month
Bev Remillard

Queen size 89 x 108

Designer Size 59 x 59

 Ladylike Designs
Romantic Quilts with Modern Design

24881 Alicia Pkwy #E168, Laguna Hills, CA 92653
www.ladylikedesigns.com

Dresden Dreams BOM

Bev Remillard

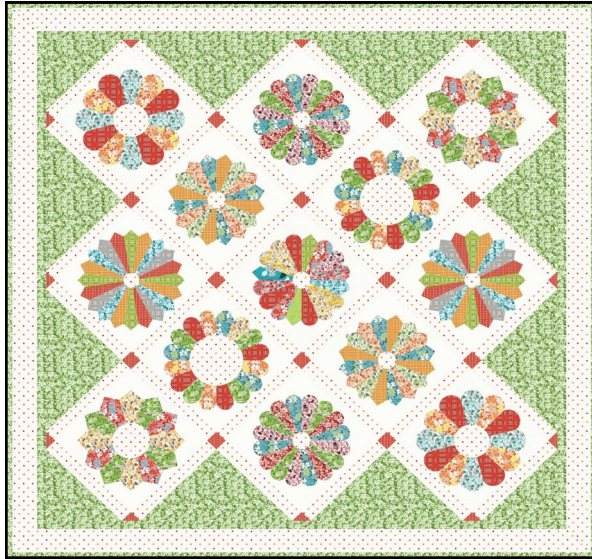

Welcome to my ongoing class
called *Dresden Dreams*.

Whether you are an unsure quilter **or** an adventurous quilter,
this class is for you.

I have admired Dresden blocks for years and once I started making them, I fell in love. I have prepared these blocks with ease and variety to make them so exciting—no more fear, this is just plain fun!

The quilt boasts a varied selection of *Dresden blocks* with my original designs using simple techniques and notions.

We will also discover plenty of tips with colorful lessons, block options and appliqué techniques by hand and machine.

I will also share layout options for your finished quilt and appliqué pizzazz for the border.

This quilt can also be prepared in queen-size.

Its time to get started with your favorite fabric collection as class starts soon!



**Color and Border Appliqué option,
demonstrated during class.**



Registration and class information is all done online, Full tutorials with lots of color pictures to help you along.

I hope you will join us for this fun class and make yourself a beautiful quilt one lesson at a time.

Looking forward to quilting with you!

Bev Remillard

Ladylike Designs
Romantic Quilts with Modern Design



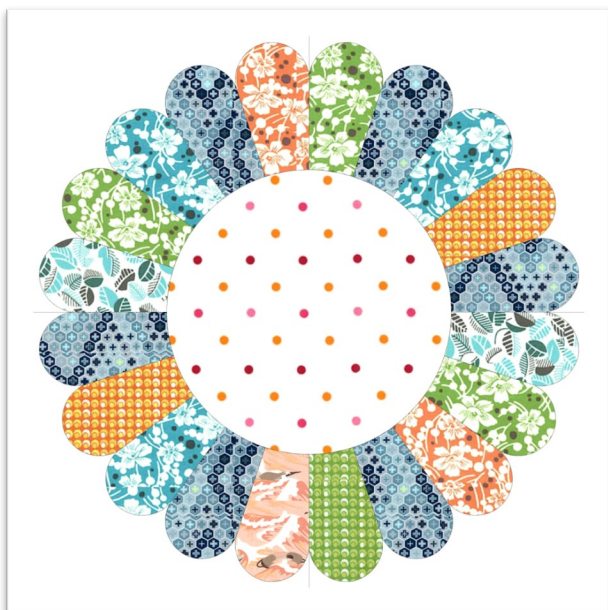

Dresden Dreams BOM

Bev Remillard—Ladylike Designs

Thank you for joining this class—we are going to have fun!!
The following fabric and supply information is what you will need to prepare and finish the top of your quilt, you will need to purchase backing separately.

Fabric Information—Designer Size

I used a line filled with bright reds, blues and greens and accented with yellow and grey. You can use a softer variety as well with pastels or even scraps. I will be sharing pillows, table runners and toppers options too.

The important thing is to choose 3-4 main colors and add 2-3 secondary colors to give each block a colorful and exciting look.

Notions/Supplies

- General Sewing Supplies
- Lightweight Fusible Webbing (for machine applique)
- Lightweight Fusible Interfacing
 - Stabilizer
- Heat Resistant Template
 - KKB Perfect Circles
- Darlene Zimmerman Dresden ruler —very helpful
- More supplies will be suggested later.

There are (13) blocks total with side triangles, sashing, etc.

Dresden Blades (variety)	1 Layer cake or 4 Charm Packs
Background (light, <i>White</i>)	1 yard
Setting Background (Med/light <i>Green</i>)	1 yard
Sashing strips (Light Med <i>Pale Orange</i>)	2/3 yard
Border 1 and Binding (Colorful, <i>Bold Print</i>)	1 yard
Border 2 (Light Print)	1 yard
Optional: Filler Flannel (white)	1/3 yard (helpful for center circles)
Backing and Batting	4-1/4 yards

Finished Size 59 x 59





Notions/Supplies

- General Sewing Supplies
- Lightweight Fusible Webbing (for machine applique)
- Lightweight Fusible Interfacing
 - Stabilizer
 - Heat Resistant Template
 - KKB Perfect Circles
- Darlene Zimmerman Dresden ruler —very helpful
- More supplies will be suggested

Dresden Dreams BOM

Bev Remillard—Ladylike Designs

Thank you for joining this class—we are going to have fun!!
The following information is for Queensize version of original quilt.
The fabric quantities will change, but supplies/notions will be the same.

Fabric Information—Queensize

There are (18) blocks total with side triangles, sashing, etc.

Dresden Blades (variety);

6 Charm Packs or (2) fat quarters of 12 choices—use 6 color groups
The important thing is to choose 3-4 main colors and add 2-3 secondary colors to give each block a colorful and exciting look.

Background (light, <i>White</i>)	1-1/2 yard
Setting Background (Med/light <i>Green</i>)	1-1/2 yard
Sashing strips (Light Med <i>Pale Orange</i>)	1 yard
Border 1 and Binding (Colorful, Bold Print)	1-1/2 yards
Border 2 (Light Print)	1-1/2 yard
Optional: Filler Flannel (white)	1/2 yard
Backing and Batting	6 yards

Finished Size 89 x 108

